

VT60

Guillotine-type surface-mounted transfer shutter E60 or EI60 (with a grill).



Table of content



Classifications	3
Product presentation VT60	4
Range and dimensions VT60	4
Evolution - kits	5
Options - at the time of order	5
Storage and handling	7
Installation	7
Operation: manual closing	7
Operation: manual opening	7
Installation in rigid wall	8
Installation in rigid wall by means of mounting frame E-VT60	8
Installation in flexible wall (metal stud gypsum plasterboard wall)	9
Electrical connection	10, 12
Installation of the grill	10
Replacement fusible link FUS72 VT60	11
Operation and mechanisms	12
Electrical connection	12
Weights	13
Selection data	14
Approvals and certificates	14

Explanation of the abbreviations and pictograms

Wn = nominal width
 Hn = nominal height
 Sn = free air passage
 E = integrity

I = thermal insulation
 60/120 = fire resistance time
 Auto = automatic
 OP = option (delivered with the product)

KIT = kit (delivered separately for repair or upgrade)
 GKB (type A) / GKF (type F): "GKB" stands for standard plasterboards (type A according to EN 520) while "GKF" plasterboards offer a higher fire resistance for a similar plate thickness (type F according to EN 520)

	optimal free air passage and minimal pressure loss		compact build-in depth
	dry mounting (surface-mount)		

CLASSIFICATIONS

CLA_V25_EN

C-05/2019

Essential characteristics		VT60		Performance Classification	
Range	Wall type	Wall	Sealing	Installation	Performance Classification
300x200 mm ≤ VT60 ≤ 800x800 mm	Rigid wall	Aerated concrete ≥ 100 mm	Not applicable	1	EI 60
	Flexible wall	Metal studs gypsum plasterboard Type A (EN 520) ≥ 100 mm	Not applicable	2	E 60
1	Type of installation: surface-mounted with grill (fire: side corridor)		2	Type of installation: surface-mounted, without grill	



The performance of the product identified above is in conformity with the set of declared performance/s. This declaration of performance is issued, in accordance with Regulation (EU) No 305/2011, under the sole responsibility of the manufacturer identified above.

Signed for and on behalf of the manufacturer by:
Mathieu Steenland, Technical Manager



Mathieu Steenland

Oosterzele, 05/2019

Product presentation VT60

Product presentation VT60

Guillotine-type transfer shutter tested according to European standard EN 1634-1 and classified E60 or EI60 (if finished with a grill at the airlock side). With its compact build-in dimensions, the VT60 is surface-mounted on light and massive walls of 100 mm. The shutter is open in the standby position and closed in the safety position; the unlocking happens only through a fusible link.

The transfer shutters are part of the smoke extraction systems in public buildings. They serve as air supply for the corridor next to an airlock.

- ☑ fast installation
- ☑ optimal free air passage and minimal pressure loss
- ☑ compact build-in depth
- ☑ lightweight
- ☑ optional in-wall installation kit



- dry mounting (surface-mount)
- suitable for surface-mounting without a mounting frame on light and rigid wall
- tested in accordance with EN 1634-1
- unlocking by fusible link
- maintenance-free
- for indoor use

1. connection compartment
2. steel frame
3. damper blade
4. fusible link
5. intumescent strip
6. slides
7. end and beginning of range switches (option)

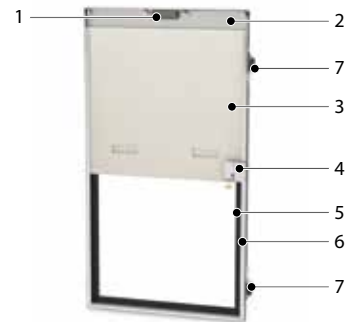

Range and dimensions VT60

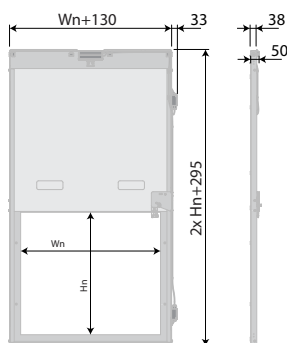

	IV	IV
(Wn x Hn) mm	300x200	800x800

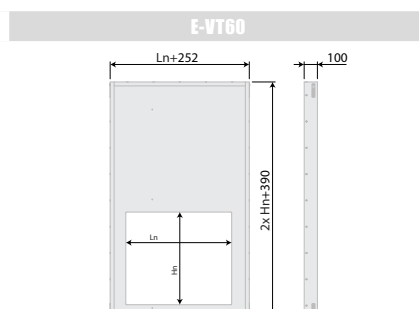
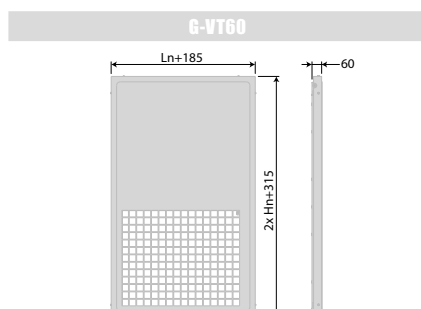

Evolution - kits



FUS72 VT60

Fusible link 72°C (per set of 2 pieces)
 A: VT60 < 1/4/2019
 B: VT60 ≥ 1/4/2019



E-VT60

Fire resistant mounting frame for rigid wall. Delivered separately as a kit.



G-VT60

Protection grill. Delivered separately as a kit.



KITS FDC VT60

Limit switches 'open/closed' (kit)

Options - at the time of order



E-VT60

Fire resistant mounting frame for rigid wall.
 VT60 will be mounted on E-VT60 when ordered as an option.



G-VT60

Protection grill.



FDC VT60

Limit switches 'open/closed' (pre-mounted)

6 Options - at the time of order



DC VT60

Limit switch 'open' (pre-mounted)

FC VT60

Limit switch 'closed' (pre-mounted)

Storage and handling

As this product is a safety element, it should be stored and handled with care.

Avoid:

- any kind of impact or damage
- contact with water
- deformation of the casing

It is recommended:

- to unload in a dry area
- not to flip or roll the product to move it
- not to use the damper as a scaffold, working table, etc.
- not to store smaller dampers inside larger ones

Installation

General points

- The installation must comply with the installation manual delivered with the product and the classification report.
- Verify if the blade can move freely.
 - ⚠ Caution: when fitting, the product should be handled with care and remain protected from any sealing products.
 - ⚠ Caution: before putting the installation into operation, clean off all the dust and dirt.

Operation: manual closing

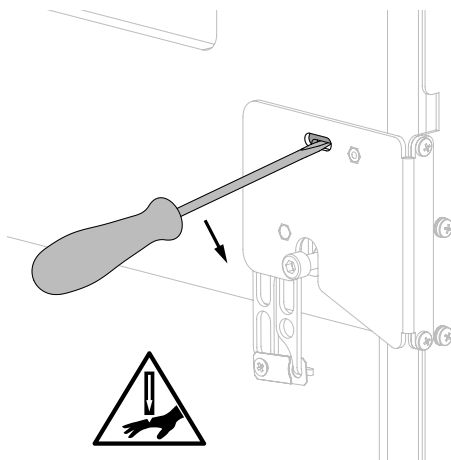
1

1. Unlock the mechanism by lifting the locking plate through the slotted hole with the help of a flat screwdriver. This action makes the shutter blade fall.

⚠ Watch out for the fingers!

Operation: manual opening

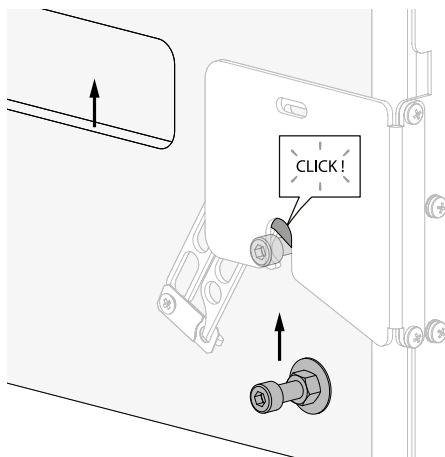
1

1. Lift the shutter blade with two hands by the integrated handles until the lock bolt snaps into the open lock.

Installation in rigid wall

The product was tested and approved in:

Range	Wall type	Sealing	Classification
$300 \times 200 \text{ mm} \leq VT60 \leq 800 \times 800 \text{ mm}$	Rigid wall	Aerated concrete $\geq 100 \text{ mm}$	EI 60
$300 \times 200 \text{ mm} \leq VT60 \leq 800 \times 800 \text{ mm}$	Rigid wall	Aerated concrete $\geq 100 \text{ mm}$	E 60

1

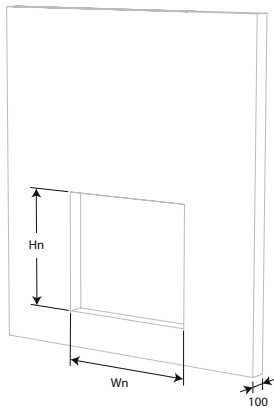

2

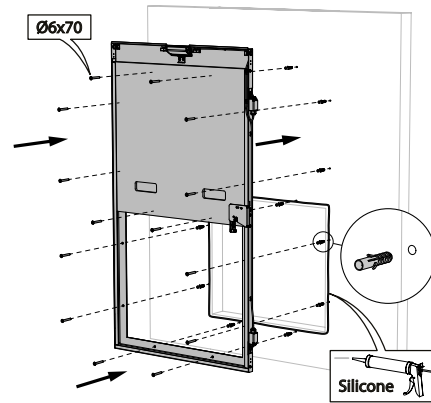

Installation in rigid wall by means of mounting frame E-VT60

The product was tested and approved in:

Range	Wall type	Sealing	Classification
$300 \times 200 \text{ mm} \leq VT60 \leq 800 \times 800 \text{ mm}$	Rigid wall	Aerated concrete $\geq 100 \text{ mm}$	EI 60
$300 \times 200 \text{ mm} \leq VT60 \leq 800 \times 800 \text{ mm}$	Rigid wall	Aerated concrete $\geq 100 \text{ mm}$	E 60

1

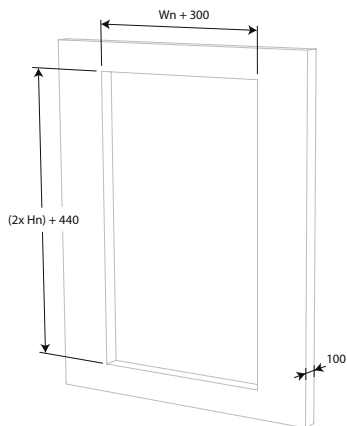

2

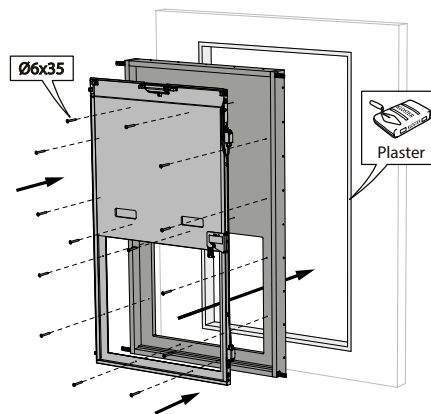

Installation in flexible wall (metal stud gypsum plasterboard wall)

The product was tested and approved in:

Range	Wall type	Sealing	Classification
$300 \times 200 \text{ mm} \leq VT60 \leq 800 \times 800 \text{ mm}$	Flexible wall	Not applicable	EI 60
$300 \times 200 \text{ mm} \leq VT60 \leq 800 \times 800 \text{ mm}$	Flexible wall	Not applicable	E 60

1

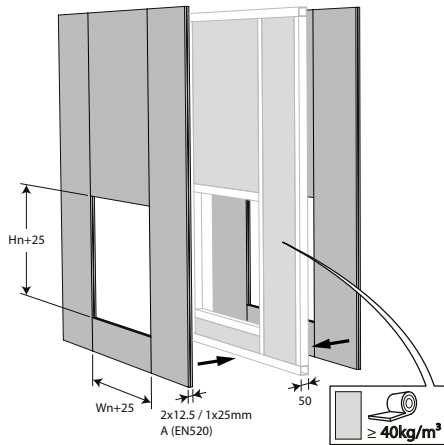

2

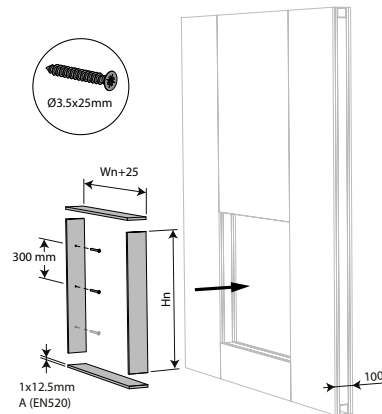

3

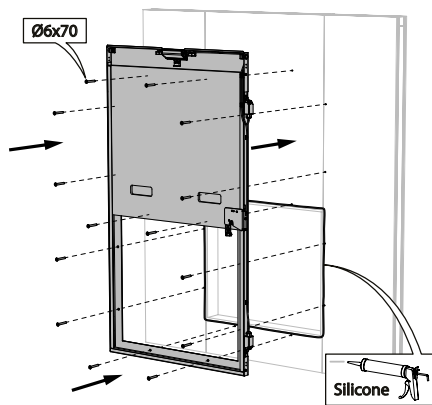

Electrical connection

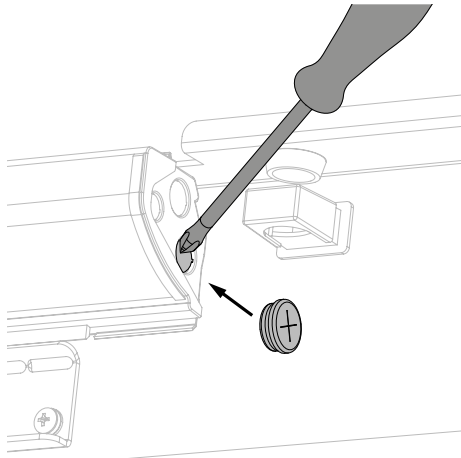
1

1. Pierce an opening in the connection box. Affix the grommet delivered with the product.

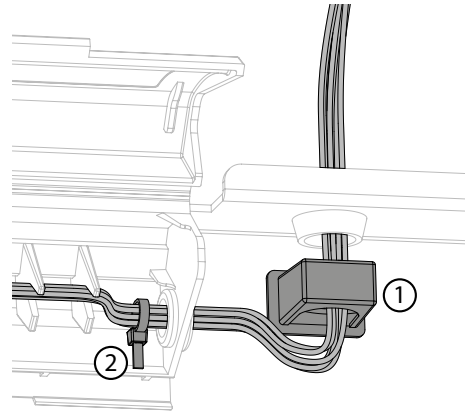
2

2. Lead the cables through the opening. Use the fixation clip (1) and the plastic cable clamp (2) to attach the cables in the connection box and connect according to the electrical connection diagram.
Comply with the installation rules according to article 6.1 of NF S 61-932.

Installation of the grill

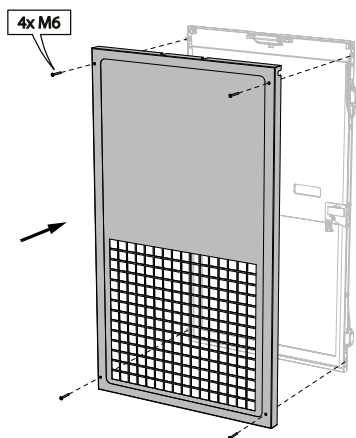
1

Replacement fusible link FUS72 VT60

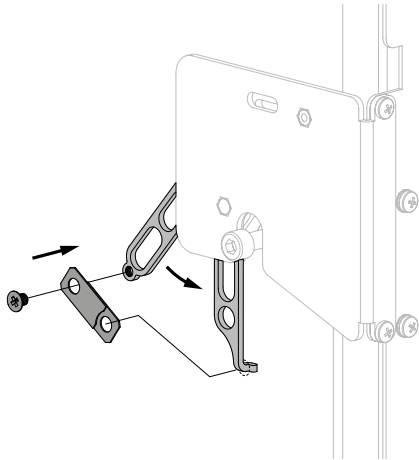
1

1. Unscrew the mounting bolt. Remove the old fusible link. Attach the new fusible over the hook and secure it with the mounting bolt.

Maintenance

- No specific maintenance required.
- Schedule at least two running visual checks each year.
- Remove dust and all other particles before start-up.
- Follow the local maintenance regulations (i.e. BS9999 Annex V; NF S 61-933) and EN13306.

Operation and mechanisms



FUS72-VT60 Fusible

The fusible link holds the blade of the damper in open position.

Options - at the time of order

FDC VT60	Limit switches 'open/closed' (pre-mounted)
DC VT60	Limit switch 'open' (pre-mounted)
FC VT60	Limit switch 'closed' (pre-mounted)

Electrical connection

FUS72-VT60

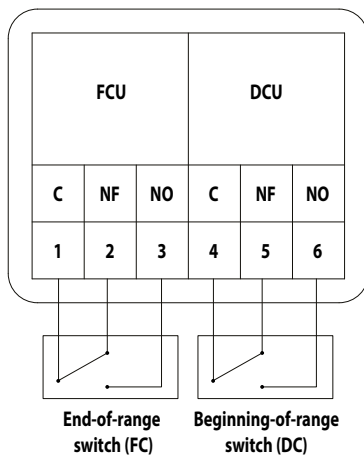

Representation of switches in stand-by position

MEC	Nominal voltage motor Nominal voltage magnet Power consumption (stand-by) Power consumption (operating)	Standard switches	Resetting time motor Running time spring Noise level motor Noise level spring	Cable supply / control Cable auxiliary switch	Protection class
FUS72-VT60	N/A	1mA...6A DC 5V...AC250V	N/A	N/A	IP 42

Weights

VT60 (weight without options)

Hn\Wn (mm)		300	350	400	450	500	550	600	650	700	750	800				
200	kg	5,6	6,3	7,0	7,6	8,3	9,0	9,7	10,3	11,0	11,7	12,4				
250	kg	6,5	7,3	8,1	8,8	9,6	10,4	11,2	12,0	12,7	13,5	14,3				
300	kg	7,4	8,3	9,2	10,1	10,9	11,8	12,7	13,6	14,5	15,4	16,3				
350	kg	7,4	8,3	9,2	10,1	10,9	11,8	12,7	13,6	14,5	15,4	16,3				
400	kg	9,2	10,3	11,4	12,5	13,6	14,7	15,8	16,9	18,0	19,1	20,2				
450	kg	10,1	11,3	12,5	13,7	14,9	16,1	17,3	18,5	19,7	20,9	22,1				
500	kg	10,9	12,3	13,6	14,9	16,2	17,5	18,8	20,1	21,4	22,7	24,1				
550	kg	11,8	13,2	14,7	16,1	17,5	18,9	20,3	21,7	23,2	24,6	26,0				
600	kg	12,7	14,2	15,8	17,3	18,8	20,3	21,9	23,4	24,9	26,4	27,9				
650	kg	13,6	15,2	16,9	18,5	20,1	21,7	23,4	25,0	26,6	28,3	29,9				
700	kg	14,5	16,2	18,0	19,7	21,4	23,2	24,9	26,6	28,4	30,1	31,8				
750	kg	15,2	17,1	19,0	20,8	22,7	24,6		28,3	30,2	32,0	33,8				
800	kg	16,1	18,1	20,1	22,0	24,0	26,0	28,0	30,0	31,9	33,8	35,8				

G-VT60

Hn\Wn (mm)		300	350	400	450	500	550	600	650	700	750	800				
200	kg	2,7	2,9	3,1	3,3	3,5	3,7	3,9	4,1	4,3	4,5	4,7				
250	kg	3,0	3,2	3,4	3,7	3,9	4,1	4,3	4,5	4,7	5,0	5,2				
300	kg	3,3	3,5	3,8	4,0	4,2	4,5	4,7	4,9	5,2	5,4	5,6				
350	kg	3,6	3,8	4,1	4,3	4,6	4,8	5,1	5,3	5,6	5,9	6,1				
400	kg	3,9	4,1	4,4	4,7	4,9	5,2	5,5	5,8	6,0	6,3	6,6				
450	kg	4,1	4,4	4,7	5,0	5,3	5,6	5,9	6,2	6,5	6,8	7,0				
500	kg	4,4	4,7	5,0	5,4	5,7	6,0	6,3	6,6	6,9	7,2	7,5				
550	kg	4,7	5,0	5,4	5,7	6,0	6,3	6,7	7,0	7,3	7,6	8,0				
600	kg	5,0	5,3	5,7	6,0	6,4	6,7	7,1	7,4	7,8	8,1	8,4				
650	kg	5,3	5,6	6,0	6,4	6,7	7,1	7,5	7,8	8,2	8,5	8,9				
700	kg	5,6	5,9	6,3	6,7	7,1	7,5	7,9	8,2	8,6	9,0	9,4				
750	kg	6,0	6,3	6,7	7,1	7,5	7,9	8,3	8,6	9,0	9,4	9,8				
800	kg	6,4	6,8	7,1	7,5	7,9	8,3	8,7	9,1	9,4	9,8	10,2				

E-VT60

Hn\Wn (mm)		300	350	400	450	500	550	600	650	700	750	800				
200	kg	9,5	10,2	10,8	11,5	12,1	12,7	13,4	14,0	14,7	15,3	15,9				
250	kg	10,5	11,1	11,8	12,5	13,2	13,9	14,6	15,2	15,9	16,6	17,3				
300	kg	11,4	12,1	12,8	13,6	14,3	15,0	15,7	16,5	17,2	17,9	18,7				
350	kg	12,3	13,1	13,8	14,6	15,4	16,2	16,9	17,7	18,5	19,2	20,0				
400	kg	13,2	14,0	14,9	15,7	16,5	17,3	18,1	18,9	19,8	20,6	21,4				
450	kg	14,1	15,0	15,9	16,7	17,6	18,4	19,3	20,2	21,0	21,9	22,7				
500	kg	15,1	16,0	16,9	17,8	18,7	19,6	20,5	21,4	22,3	23,2	24,1				
550	kg	16,0	16,9	17,9	18,8	19,8	20,7	21,7	22,6	23,6	24,5	25,5				
600	kg	16,9	17,9	18,9	19,9	20,9	21,9	22,9	23,8	24,8	25,8	26,8				
650	kg	17,8	18,9	19,9	20,9	22,0	23,0	24,0	25,1	26,1	27,1	28,2				
700	kg	18,8	19,8	20,9	22,0	23,1	24,1	25,2	26,3	27,4	28,5	29,5				
750	kg	19,7	20,8	21,9	23,0	24,2	25,3	26,4	27,5	28,7	29,8	30,9				
800	kg	20,6	21,8	22,9	24,1	25,3	26,4	27,6	28,8	29,9	31,1	30,6				

Selection data

VT60 - Free air passage (m²)

Hn\Wn [mm]		300	350	400	450	500	550	600	650	700	750	800
200	Sn [m ²]	0,0600	0,0700	0,0800	0,0900	0,1000	0,1100	0,1200	0,1300	0,1400	0,1500	0,1600
250	Sn [m ²]	0,0750	0,0875	0,1000	0,1125	0,1250	0,1375	0,1500	0,1625	0,1750	0,1875	0,2000
300	Sn [m ²]	0,0900	0,1050	0,1200	0,1350	0,1500	0,1650	0,1800	0,1950	0,2100	0,2250	0,2400
350	Sn [m ²]	0,1050	0,1225	0,1400	0,1575	0,1750	0,1925	0,2100	0,2275	0,2450	0,2625	0,2800
400	Sn [m ²]	0,1200	0,1400	0,1600	0,1800	0,2000	0,2200	0,2400	0,2600	0,2800	0,3000	0,3200
450	Sn [m ²]	0,1350	0,1575	0,1800	0,2025	0,2250	0,2475	0,2700	0,2925	0,3150	0,3375	0,3600
500	Sn [m ²]	0,1500	0,1750	0,2000	0,2250	0,2500	0,2750	0,3000	0,3250	0,3500	0,3750	0,4000
550	Sn [m ²]	0,1650	0,1925	0,2200	0,2475	0,2750	0,3025	0,3300	0,3575	0,3850	0,4125	0,4400
600	Sn [m ²]	0,1800	0,2100	0,2400	0,2700	0,3000	0,3300	0,3600	0,3900	0,4200	0,4500	0,4800
650	Sn [m ²]	0,1950	0,2275	0,2600	0,2925	0,3250	0,3575	0,3900	0,4225	0,4550	0,4875	0,5200
700	Sn [m ²]	0,2100	0,2450	0,2800	0,3150	0,3500	0,3850	0,4200	0,4550	0,4900	0,5250	0,5600
750	Sn [m ²]	0,2250	0,2625	0,3000	0,3375	0,3750	0,4125	0,4500	0,4875	0,5250	0,5625	0,6000
800	Sn [m ²]	0,2400	0,2800	0,3200	0,3600	0,4000	0,4400	0,4800	0,5200	0,5600	0,6000	0,6400

Approvals and certificates

All our products are submitted to a number of tests by official test institutes. Reports of these tests form the basis for the approvals of the products.



18.30

The NF-label guarantees: conformity with the standard NF S 61-937 Parts 1 and 11: "Systèmes de Sécurité Incendie Dispositifs Actionnés de Sécurité"; conformity with the national decree of March 22, 2004, changed on 14 March 2011 for the classification of fire resistance; the values of the characteristics mentioned in this document. Organisme Certificateur: AFNOR Certification, 11 Rue Francis de Pressensé, F93571 La Plaine Saint-Denis Cedex; Website: <http://www.afnor.org> <http://www.marque-nf.com>; Phone: +33 (0)1.41.62.80.00, Fax: +33 (0)1.49.17.90.00, Email: certification@afnor.org